

AFTER RECORDING, RETURN TO:

NorthWestern Energy
Lands & Permitting Department
11 East Park Street
Butte, MT 59701-1711

GENERAL RELEASE OF EASEMENT

THIS GENERAL RELEASE OF EASEMENT is given this ____ day of _____, 2023, by **NORTHWESTERN CORPORATION D/B/A NORTHWESTERN ENERGY**, a Delaware corporation (successor in interest to the Montana Power Company), 11 East Park Street, Butte, MT 59701-1711 "GRANTOR", to University of Montana, 32 Campus Drive, Missoula, MT 59812, "GRANTEE".

The Grantor, for and in consideration of the sum of \$1.00 and other good and valuable consideration, to it in hand paid, the receipt of which is acknowledged, has remised and released, and does remise and release forever, unto the Grantee, its heirs and assigns, all of Grantor's right, title and interest in and to the herein described easement depicted on the attached Exhibit A, affecting that certain parcel of land located in **Missoula County, Montana** and particularly described as follows:

TOWNSHIP 13 NORTH, RANGE 19 WEST, P.M.M., MISSOULA COUNTY, MONTANA.

Section 22: Parcel B, Certificate of Survey No. 2558, on file and of record in the office of the Clerk & Recorder of Missoula County, Montana.

AND

Block 17 of the Montana Addition, a platted subdivision in the City of Missoula, Missoula County, Montana, according to the official recorded plat thereof, on file and of record in the office of the Clerk & Recorder of Missoula County, Montana.

This instrument is made, executed and delivered to release of record that certain prescriptive Easement pertaining to the above described parcel of land and listed as follows:

1. Easement in favor of The Montana Power Company, for easement rights acquired, through prescription, for access and maintenance of a medium pressure 8" natural gas distribution pipeline, installed circa 1972.

Excepting and Reserving unto Grantor, any other easements affecting the Property that are not specifically herein released.

In all other respects, the easements as referenced remain unchanged.

Exhibit "A"

The following is made a part of that certain Release of Easement dated _____ by and between University of Montana, as "Grantor" and Northwestern Corporation D/B/A NorthWestern Energy as "Grantee".

All distances, areas and measurements shown below are approximate and not to scale

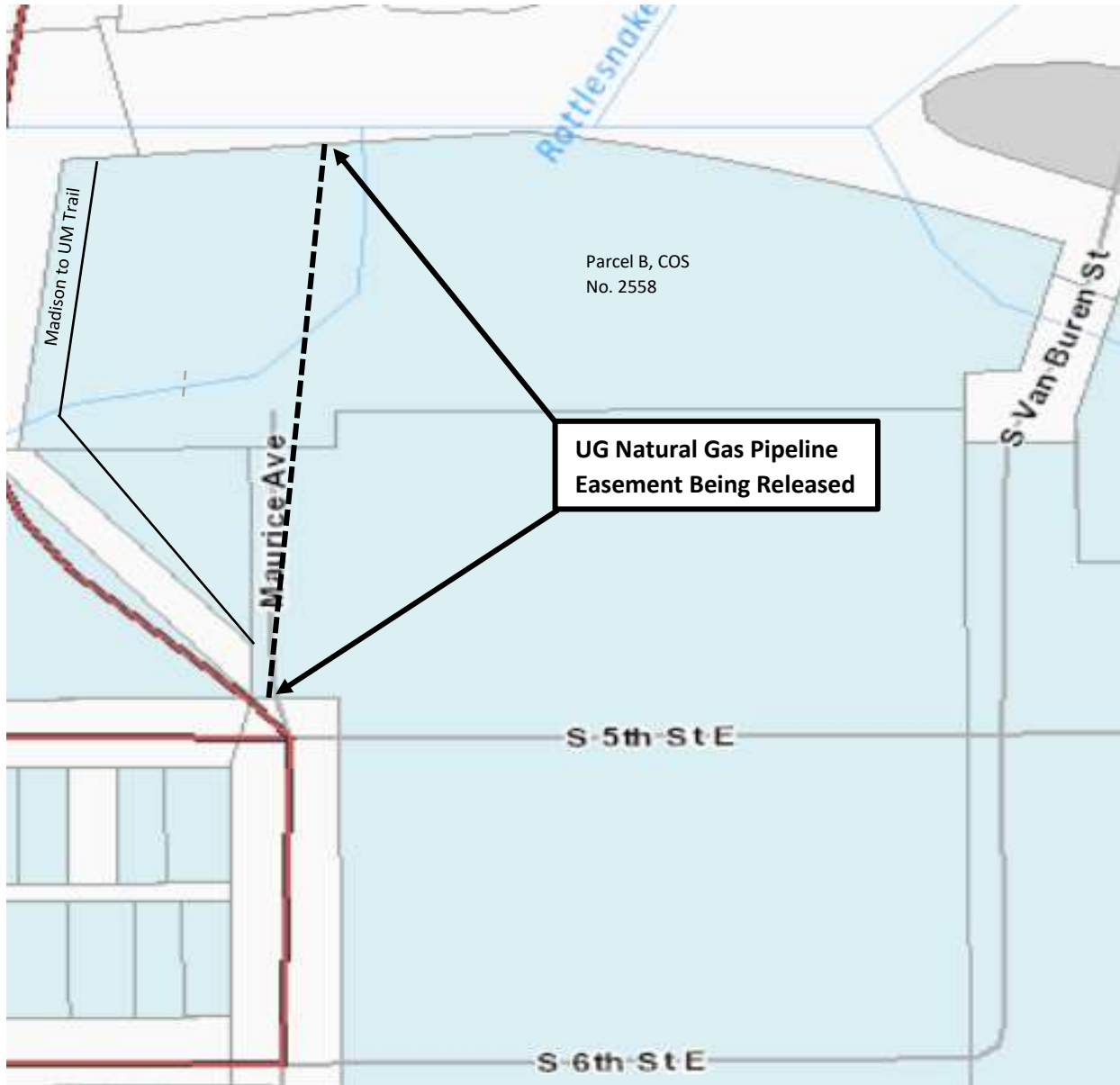

TOWNSHIP 13 NORTH, RANGE 19 WEST, P.M.M., MISSOULA COUNTY, MT.

Section 22: **Please see lengthy legal description on following page**

Exhibit "A"

The following is made a part of that certain Release of Easement dated _____ by
and between University of Montana, as "Grantor" and Northwestern Corporation D/B/A
NorthWestern Energy as "Grantee".

All distances, areas and measurements shown below are approximate and not to scale

Parcel B, Certificate of Survey No. 2558, on file and of record in the office of the
Clerk & Recorder of Missoula County, Montana.

AND

Block 17 of the Montana Addition, a platted subdivision in the City of Missoula,
Missoula County, Montana, according to the official recorded plat thereof, on file
and of record in the office of the Clerk & Recorder of Missoula County, Montana.