

ATTACHMENT #2
Selected 50% Construction Documents
Plan Set Sheet (Floor Plan)

January 2026 BOR
PA Office Renovations, Eck Hall Phase 8

EXISTING MEMBRANE ROOF TO REMAIN. REFER TO MECHANICAL DRAWINGS FOR PLACEMENT OF NEW EQUIPMENT AND PENETRATIONS.

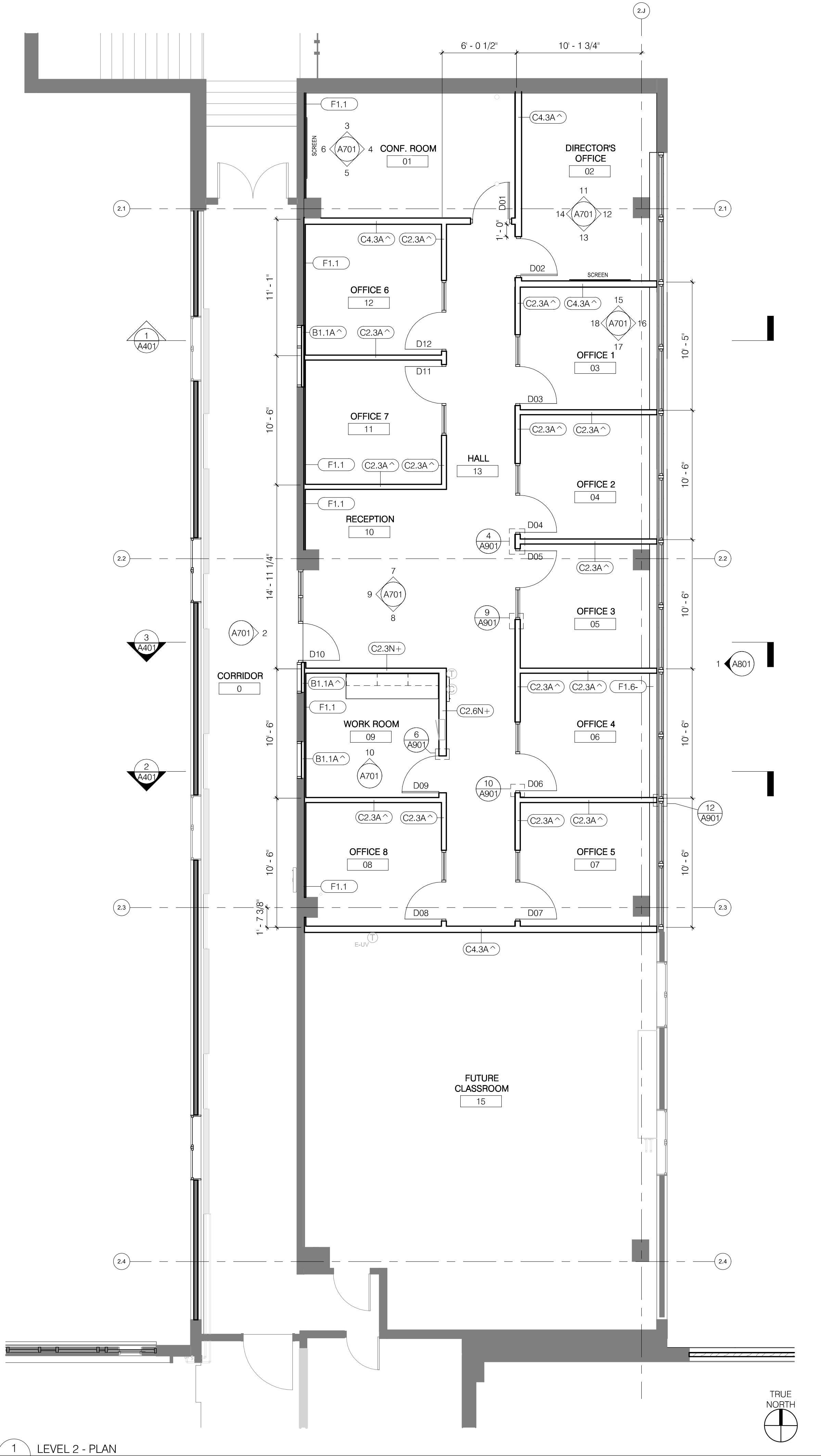

FLOOR PLAN NOTES

- SEE SHEET AG00 FOR GENERAL NOTES.
- SEE SHEET AG01 FOR TYPICAL ACCESSIBILITY CLEARANCE REQUIREMENTS.
- SEE SHEET A900 FOR INTERIOR PARTITION TYPES.
- SEE SHEET A910 FOR DOOR SCHEDULE.
- SEE INTERIOR ELEVATIONS FOR VERTICAL DIMENSIONS AND TYPICAL FIXTURE AND ACCESSORY MOUNTING HEIGHTS.
- DIMENSIONS ARE TO:
A. FACE OF STUD.
B. GRIDLINE.
- DIMENSIONS AND REFERENCE TAGS ARE SHOWN ON ENLARGED PLANS WHEN ENLARGED PLANS ARE PROVIDED.
- REFER TO CODE SHEETS FOR FIRE RESISTANCE RATING REQUIREMENTS AND EXTENT. ATTACHMENT AND ASSEMBLY OF MATERIALS MUST COMPLY WITH REQUIREMENTS OF U.L. LISTINGS PER "FIRE RESISTANCE DIRECTORY", WHERE LISTED.
- WHERE RATED WALLS ARE SHORTER THAN COMPLETE RATING DEPICTION, RATE WALL THE SAME AS ADJOINING WALL.

FLOOR PLAN LEGEND

- EXISTING PARTITION WALL
- NEW PARTITION WALL
- INTERIOR WINDOW/SIDELIGHT
- ELEMENT BY OWNER/TENANT AS NOTED
- CORNER GUARD
- FIRE EXTINGUISHER
- FIRE EXTINGUISHER CABINET

ROOF PLAN NOTES

- CONFIRM LOCATION OF ALL PENETRATIONS BEFORE BEGINNING WORK.
- MAINTAIN 12 INCHES CLEAR BETWEEN ALL ROOF ITEMS TO ALLOW SUFFICIENT ROOM FOR PROPER PENETRATION INSTALLATION.
- NOT EVERY PARAPET WALL, COPING, CURB AND FLASHING CONDITION IS ILLUSTRATED OR DETAILED. ROOFING BLOCKING, FLASHING, REGLETS, COPING ETC. SHALL BE INSTALLED FOR A FULLY WATERPROOF ASSEMBLY IN ACCORDANCE WITH THE ROOFING MANUFACTURERS' RECOMMENDATIONS AND THE DESIGN AND REFERENCE STANDARDS OF SMACNA'S ARCHITECTURAL SHEET METAL MANUAL, CURRENT EDITION.
- REFER TO DOCUMENTS OF OTHER TRADES FOR INFORMATION INCLUDING, BUT NOT LIMITED TO ADDITIONAL CURBS, HOUSEKEEPING PADS, EQUIPMENT PADS, ROOF DRAINS, CUT-OUTS, BOX-OUTS, BLOCK-OUTS, SLAB OPENINGS, PENETRATIONS NOT SHOWN ON ARCHITECTURAL PLANS. REFER TO ALL DOCUMENTS FOR COORDINATION AND EXTENT OF ADDITIONAL WORK.

ROOF PLAN LEGEND

- THE FOLLOWING SYMBOLS ARE SHOWN ONLY WHERE LAYOUT IS CRITICAL FOR AESTHETICS. THE ACTUAL DESIGN MAY CALL FOR MORE THAN WHAT IS SHOWN. NOT ALL SYMBOLS MAY BE USED.
- DOWNSPOUT
 - ROOF DRAIN AND OVERFLOW DRAIN
 - ROOF SLOPE (1/4" / 12" MIN.)

PRELIMINARY,
NOT FOR
CONSTRUCTION

Hennebery Eddy

HENNEBERY EDDY ARCHITECTS, INC.
PORTLAND OFFICE
921 SW WASHINGTON ST, SUITE 250
PORTLAND OREGON 97205
503 227 4860 TEL
503 227 4920 FAX
BEND OFFICE
1000 NW WALL ST, SUITE 250
BEND OREGON 97703
541 313 6779 TEL
BOZEMAN OFFICE
109 NORTH ROUSE AVE, SUITE 1
BOZEMAN MONTANA 59715
406 585 1112 TEL
www.henneberyeddy.com

University of Montana

UM LIBERAL ARTS - ECK
HALL - PHASE 8

University of Montana, Liberal
Arts, 32 Campus Dr #101A,
Missoula, MT 59812

HEA Project no. 25045-01
Date: December 12, 2025
50% Construction Documents
Revisions:

Drawn by: TK
Checked by: JD
Sheet:
LEVEL 2 - FLOOR &
ROOF PLAN

A201
Copyright 2025 Hennebery Eddy Architects, Inc.